

# Parkheath

*Sold on Service*

---

**Priory Road NW6**

**£2,100 PCM (£485 per week) - Camden Band E**



Attractive 1 bedroom apartment

Wood flooring and high ceilings throughout

Comfortable reception room

Bathroom/WC with underfloor heating

Excellent local transport links and amenities nearby

South Hampstead conservation area

First floor flat within an impressive period conversion

Fitted kitchen with Miele oven and dishwasher

Spacious bedroom featuring bespoke wall-to-wall fitted wardrobes

EPC: Rating C, Council Tax: Camden Band E

West Hampstead Office 020 7794 7111

## Priory Road

Approximate Gross Internal Area = 50.8 Sq m / 547 sq ft

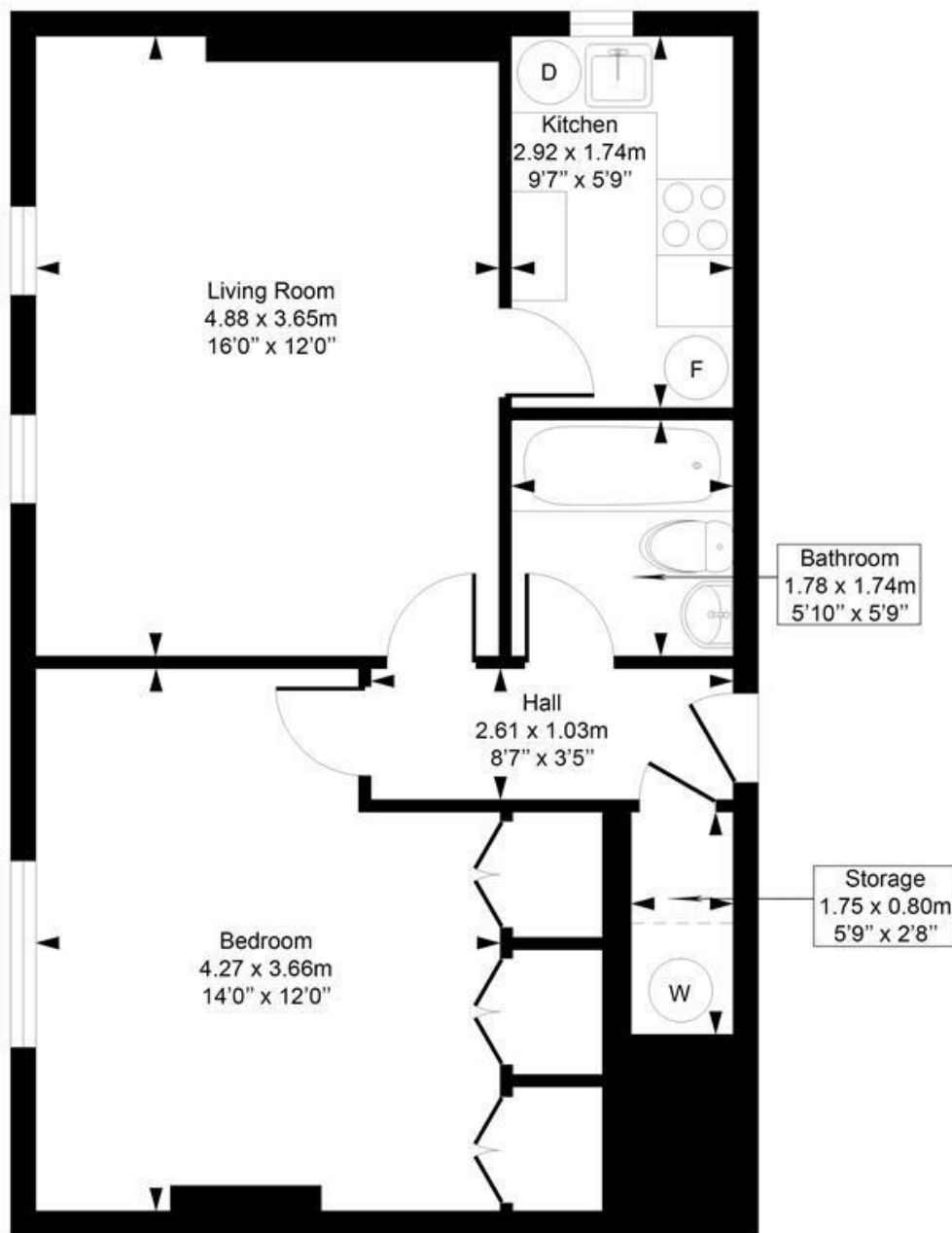

### First Floor

Measured in accordance with RICS guidelines. Every attempt is made to ensure accuracy

However all measurements are approximate.

The floor plan is illustrative purposes only and is not to scale

ELLIE CLAIRE PHOTOGRAPHY LTD

[www.ellieclairephotography.com](http://www.ellieclairephotography.com)

The particulars do not constitute part of an offer or contract. The particulars, including text, photographs and plans, are for the guidance only of prospective purchasers/tenants and must not be relied upon as statements of fact. The descriptions provided therein represent the opinion of the author and whilst given in good faith should not be construed as statements of fact. Nothing in these particulars shall be deemed a statement that the property is in good condition or otherwise or that any services or facilities are in good working order. All measurements are approximate